

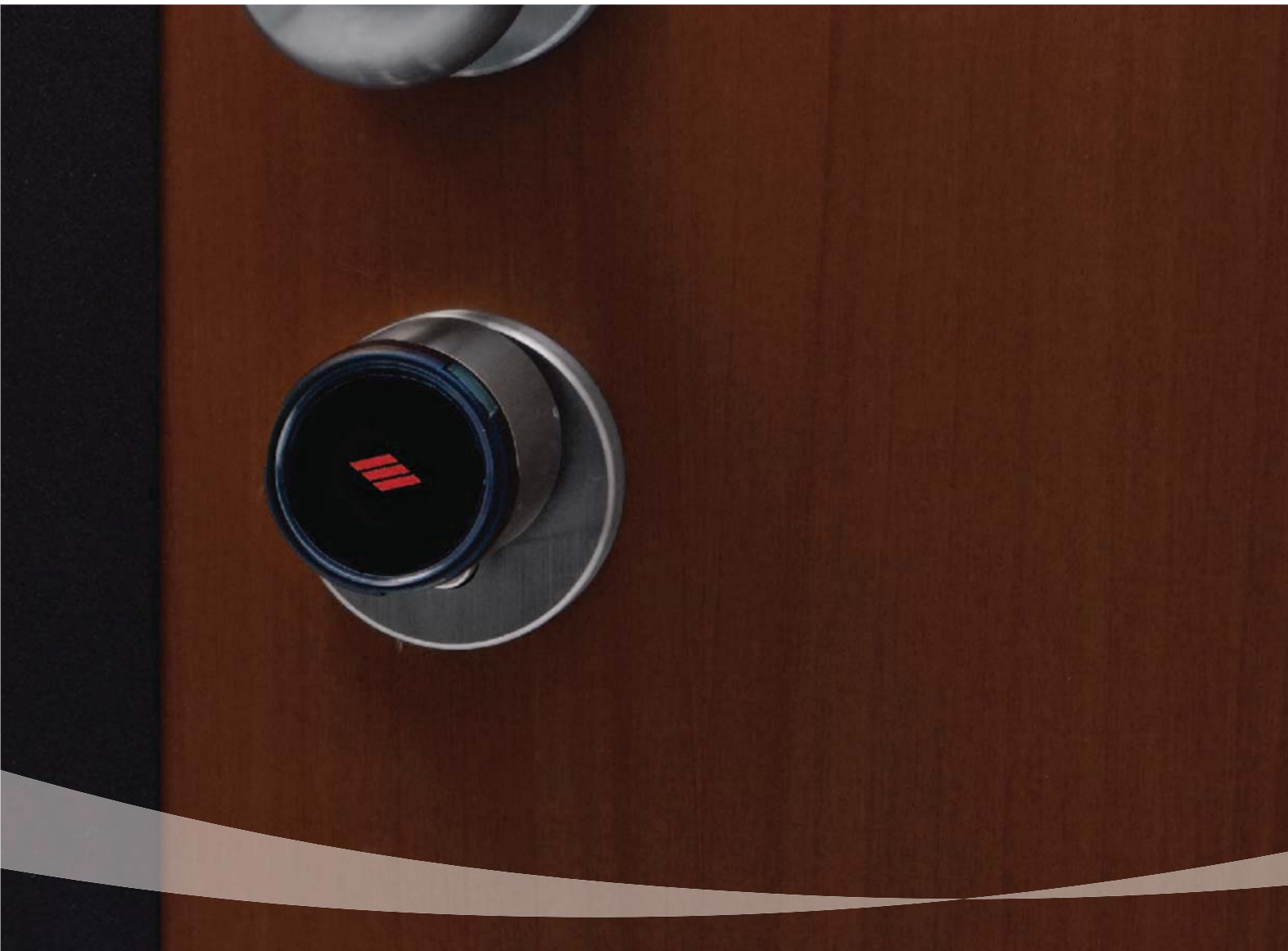

*Wave Mode
Electronic cylinder*





CISA



Wave Mode. Electronic cylinder



Wave Mode

Wave Mode Electronic cylinder

Wave Mode is the CISA contactless locking system for hotels and other communities that combines the most advanced technologies with simplicity of use.

Wave Mode extends its range of contactless access control with an electronic cylinder.

Robust, compact, elegant, Wave Mode electronic cylinder can be installed easily and quickly on any kind of doors (timber, aluminum, glass, fire-rated doors, etc) just like a standard mechanical cylinder.

Wave Mode electronic cylinder can be integrated in the existing Wave Mode systems, allowing CISA customers to extend the electronic access control to all entry points (back of desk, common areas, offices, etc).

Wave Mode electronic cylinder is interchangeable with European profile cylinders, making it simple and quick to migrate from existing mechanical systems to the latest contactless technology.

Benefits

- Compatible with Wave Mode cards.
- Easy and quick installation on any kind of door with any mechanical lock using European profile cylinder.
- Simplicity of use: to open the door simply present the card and turn the electronic head.
- Battery power supply: no need of cabling.

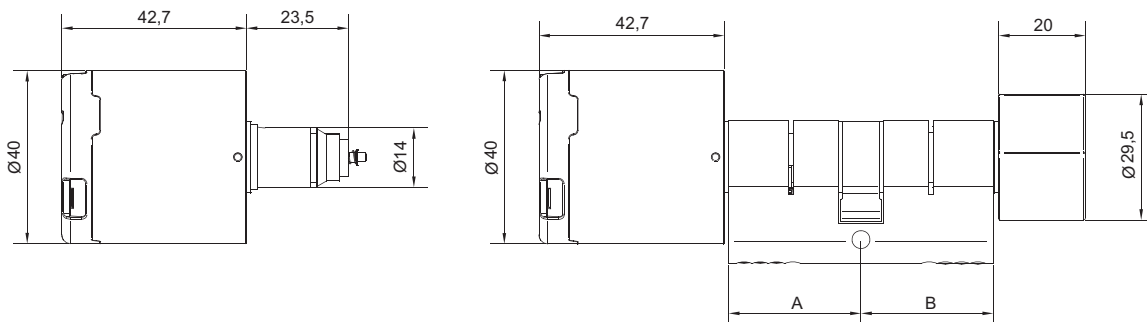

Cylinder body dimensions (A-B) available from 26/26 to 70/70 mm increasing in 5 mm incremental steps.

STANDARD MODEL

Double cylinder with electronic head on one side.



DOUBLE MODEL

Double cylinder with electronic head on both sides.



SINGLE MODEL

Half cylinder with an electronic head.



TECHNICAL FEATURES

Characteristics

- Cylinder body and knob in nickel plated brass.
- Simply push fit installation.
- Multi-standard reader ISO 14443A (Mifare) and 14443B compatible.
- 2 possible status: normal and always ON (office function).
- Technical management: initialization, battery change and audit-trail read-out via service cards.

Wave Mode Mobile

For managing and encoding access and service cards.



Dimensions (mm)

Cylinder body	Cylinder dimensions for European mechanical locks accordingly to DIN 18254
Electronic head	40 x 42,7
Mechanical thumb turn	29,5 x 20

Power supply

Batteries	2 lithium batteries RV type CR-2
Batteries life	30.000 cycles (3 years approx)
Emergency opening (batteries down)	Always possible using Low Power adaptor

Operating temperature

Range	-20°C/+65°C
-------	-------------

CERTIFICATION

Wave Mode Electronic Cylinder is compliant to European Directive on the Electromagnetic compatibility 89/336/CEE and subsequent modifications (92/31/CEE - 93/68/CEE).

CISA S.p.A. reserves the right to modify the products illustrated in this catalogue without any prior notice. All given measurements are expressed in millimeters.



Ingersoll Rand's Security Technologies Sector is a leading global provider of products and services that make environments safe, secure and productive. The sector's market-leading products include electronic and biometric access-control systems; time-and-attendance and personnel scheduling systems; mechanical locks; portable security; door closers, exit devices, architectural hardware, and steel doors and frames; and other technologies and services for global security markets.

CISA SpA
Via Oberdan, 42
48018 Faenza (RA) Italy
Tel. +39 0546 677111
Fax +39 0546 677150
www.cisa.com

www.ingersollrand.com

PDE 634 2010 Edition.

© 2006 Ingersoll-Rand Company Limited